

Technical Data Sheet

CODE 15000

TIRACAMINO TC 10 M

Radial chimney fan



Certifications



TECHNICAL AND PERFORMANCE DATA

Frequency (Hz)	50-60	Max airflow (m ³ /h)	750
Insulation class	I ^o	Max airflow at 60 Hz (l/s)	252
IP	X4	Max airflow at 60 Hz (m ³ /h)	910
Max absorbed current (A)	0,5	Max pressure (mmH2O)	19
Max absorbed power (W)	120	Max pressure (Pa)	186
Max absorbed Power at 60 Hz (W)	150	Max pressure at 60 Hz (mmH2O)	26
Nominal diameter (mm)	180	Max pressure at 60 Hz (Pa)	255
Voltage (V)	220-240	Max RPM	1400
Weight (Kg)	14,3	RPM	1400
Max airflow (l/s)	208	Sound pressure Lp [dB (A)] at 3 m	52

DIMENSIONS

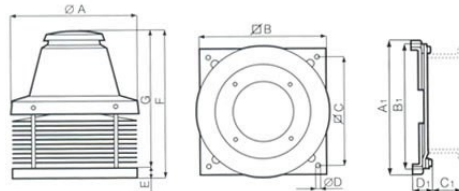

Size A (mm)	Ø 405 - A1 401
Size B (mm)	410 - B1 357
Size C (mm)	357 - C1 140
Size D (mm)	Ø 10 - D1 40
Size E (mm)	38
Size F (mm)	518
Size G (mm)	480

PER INFORMAZIONI / FOR INFORMATION

ITALY

Pre Sales:
prevendita@vortice-italy.com
After Sales:
postvendita@vortice-italy.com

UNITED KINGDOM & REP. OF

IRELAND
Sales Dept:
sales@vortice.ltd.uk
Technical Dept:
technical@vortice.ltd.uk

OTHER COUNTRIES

Sales Dept:
export@vortice-italy.com
After Sales:
after-sales@vortice-italy.com

Technical Data Sheet

CODE 15000

TIRACAMINO TC 10 M

Radial chimney fan



DESCRIPTION

- Base manufactured from phosphated pressed steel, epoxy powder coated with hammered effect finish, guaranteeing long-term resistance to atmospheric agents.
- Aerodynamically contoured inlet port for optimum performance, fashioned as a single unit with the base and gauged to optimize air flow.
- Pressed steel motor cover: pickled and phosphated surface, polyester powder coated and oven baked finish, colour grey, with hammered texture.
- Asynchronous motor with thermal overload cutout and shaft turning in ball bearings, coupled to backward curved impeller with dynamically balanced self-cleaning aluminium blades (UNI ISO 1940, Point 1 – Class

- 6.3).
- Maximum airflow: 750 m³/h.
- Protection grille with anti-bird rings (in accordance with UNI ISO 13857 standard), made of electrically welded steel; epoxy paint finish, colour black.
- Sub-frame for fixing the appliance to the flue stack.
- Equipped with steel safety wire for anchoring the appliance once installed.
- Designed for use at a continuous operating temperature of 200 °C.
- Variable speed controller supplied as standard.

CURVES

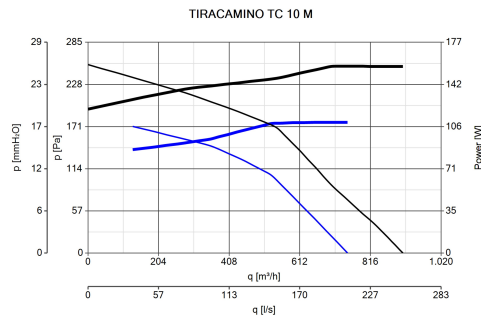

ACCESSORIES

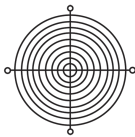

**TR-G 10/15
(GRIGLIA DI
PROTEZIONE)**

Code 22700



**KIT SCB
(TRASF.E.C.)**

Code 22481

PER INFORMAZIONI / FOR INFORMATION

ITALY

Pre Sales:
prevendita@vortice-italy.com

After Sales:
postvendita@vortice-italy.com
UNITED KINGDOM & REP. OF

IRELAND

Sales Dept:
sales@vortice.ltd.uk
Technical Dept:
technical@vortice.ltd.uk

OTHER COUNTRIES

Sales Dept:
export@vortice-italy.com

After Sales:
after-sales@vortice-italy.com